

全国免费服务热线
Toll free national hotline

400-9903-678

上下有限，服务无限

SPACE IS LIMITED , UNLIMITED SERVICE

格尔森电梯有限公司

GERSON ELEVATOR CO.,LTD

地址：浙江省湖州市南浔区南浔镇兴园路355号

Address: No.355 Xingyuan Road, Nanxun Town, Huzhou City, Zhejiang Province, China.

电话(Tel) : 0572-2900712

传真(Fax) : 0572-2923993

网址(Web) : www.gersonlift.com

中国平安 格尔森电梯产品由中国平安财产保险股份有限公司承保
PING AN 24小时报案热线：95511

本书为一般信息类出版物，我们保留随时更改产品设计和说明的权利。
本书的任何字句，无论其字面意思或含义，对于任何产品及产品的用途和质量，或者任何购销合同条款的表述与更改均不承担任何责任。
由于印刷工艺的局限，实际加工的颜色可能与本册略有不同之处，最终造型可根据实际材料和色样决定。

It is an ordinary information publication. We keep the right of alter the product design and description at any time.
If there is any dispute out of the literal meaning of any product description, use or quality, the description and alteration of any sales contract, our company will not bear any responsibilities therefrom.
Because of the restriction of the printing technology if there is any slight difference between the actually machining color and that from this pamphlet, please take the actual material and color sample as the criterion.

 **GES ELEVATOR**



GERSON ELEVATOR CO.,LTD

格尔森电梯有限公司

载货系列电梯 
CARGO SERIES ELEVATOR

国际格尔森 创新引领者

INTERNATIONAL GERSON INNOVATIVE FORERUNNER

德国·索伦堡公司进入中国，在中国浙江南浔合资成立了格尔森电梯有限公司，并设立亚太总部和研发中心，成为一家集研发、设计、制造、销售、安装、维护为一体的专业化综合性电梯制造企业。

公司产品涵盖小（无）机房乘客电梯、观光电梯、医用电梯、别墅电梯、载货电梯、无机房载货电梯、汽车电梯、杂物电梯、自动扶梯、自动人行道等系列产品。

“追求卓越科技、为客户打造至美电梯乘坐空间”是格尔森电梯素来坚持的价值理念，融德国先进的控制技术于电梯系统内、依托优秀的研发团队、在技术上不断突破，实现了技术转移和整机品质提升，本着“用心选材、精心制造、以人为本、科学管理、注重研发、严把质量”关的总体思路下，以行动落实用户权益，为全球客户量身定制专属产品，最大程度满足的多样化需求。

Suolun burg gmbh entered into China, and established GERSON Elevator Co.,ltd. in nanxun Zhejiang China. Asian-Pacific headquarter and research and development center set.

Company's products cover a small (not) machine room passenger elevator, sightseeing elevator, medical elevator, villa elevator, cargo elevator, machine roomless freight elevator, car elevator, sundries elevators, escalators, automatic sidewalks, etc. Series of products.

"Pursuit of excellence in science and technology, and build for the customer to the GERSON elevator ride space" is the elevator always adhere to the value of philosophy, Germany advanced control technology in the elevator system, relying on excellent research and development team, constantly breakthroughs in technology, for technology transfer and overall quality, in line with "carefully select material, elaborate manufacture, people-oriented, scientific management, pay attention to research and development, strict quality" have closed, under the general idea of action to carry out the rights and interests of users, tailor exclusive products for global customers, maximize meet the diverse needs of customers.



格尔森电梯 精品制造专家

GERSON ELEVATOR Manufacture specialist of superior elevators & escalators



中德合资·德国索伦堡公司

China-germany A joint venture-suolun burg gmbh

中方：格尔森电梯有限公司

德方：德国Suolun Burg Gmbh公司

格尔森电梯有限公司与德国·索伦堡公司合资共同创立的高端电梯品牌。

公司依托合资优势，引进德国丰富的管理经验及先进的生产理念，共同研发、制造具有德国工业品质的电、扶梯产品，为城市的垂直交通缔造完美客流解决方案。

格尔森电梯一直专注于电梯设备与产品的开发与制造，为电梯产业提供配套产品，帮助客户实现价值最大化。公司推行智能化、人性化、工业化及高新技术化，让格尔森电梯成为行业内备受客户信赖、员工骄傲、社会认可和合作伙伴尊重的一家德系电梯品牌公司。

GERSON is a high-end elevator brand jointly established by Gerson Elevator Co.,LTD and Germany. Solenburg co.

With the advantages in the joint venture company, the introduction of Germany rich management experience and advanced production concept, common research and development, manufacture with German industrial electricity, escalator products, make perfect for urban vertical transportation passenger flow solutions.

GERSON elevator has been focused on the development and manufacture of elevator equipment and products, providing supporting products for the elevator industry to help customers realize the maximization of value. The company pursues intelligent, humane, industrialized and high-tech, so that the GERSON elevator invator industry has become a customer trust, employee pride, social recognition and partner respect of a German elevator Brand Company.



中德合资



ISO 9001



3C认证标志

德系风范·奢享生活

German style · Enjoy life

低碳排放， 开拓可持续发展的社会

Low carbon
demission, explore sustainable society



永磁同步无齿轮曳引机

Permanent magnet synchronous
Gearless traction machine

采用高效节能的永磁同步无齿轮驱动技术,配置进口原装高分辨率的余弦编码器,保证了电梯超平稳舒适的运行品质。

Using energy-efficient permanent magnet synchronous gearless drive technology ,configuration, import original high-resolution cosine encoder to ensure that the elevator is running super smooth and comfortable quality.



节省空间

Save space

通过开发紧凑型无齿轮曳引机和小型控制屏,格尔森电机已成功地将通常为井道面积两倍的机房面积降至与井道面积一致(*1)该款电梯具备最先进的功能,但所需机房面积不大,从而充分利用了建筑空间。

By developing a compact gearless traction machine and a small control panel, GERSON motor has been successfully reduced to the shaft area is generally twice the room area is consistent with the well area(*1). Which elevator with the most advanced features, but the small size of the room needed to take full advantage of the architectural space.

传统电梯机房
Traditional elevator
machine room



机房面积: 13m² -9m²

紧凑型电梯机房
Compact elevator
machine room



机房面积: 4m²

备注:

*1:以下三种情况机房面积会比井道面积稍大:

- (a)除控制柜外,当某些备选功能需要在机房安装额外的控制柜时
- (b)当轿厢内部尺寸(AA)小于1600mm
且中分开门宽度(JJ)小于900mm,
或旁开开门宽度(JJ)小于1100mm。

*2:当额定载重为1050KG,额定速度为1.75m/s,机房面积在约可以减少9m²。

Note:

*1: The following three scenarios room area slightly larger than the shaft area

- (a)In addition to the control cabinet when certain optional features to install additional control cabinet in the room when.
- (b)When the internal dimensions of the car(AA)is less than the open width of 1600mm and equatorial(JJ)is less than 900mm.

Or next to the open door width (JJ)is less than 1100mm

*2: When the rated load of 1050KG, rated speed of 1.75m/ s, room size can be reduced about 9m²

优势特点:

Advantage characteristics



节能环保、绿色科技

Energy saving, Green science and technology

格尔森系列载货电梯其消耗的能量与传统曳引机相比,节省能源33%以上。而且无需用油,从而消除了传统曳引系统和液压系统中油污染及火灾的潜在危险。

GERSON series lifts its energy consumption compared with traditional traction machine. Save energy more than 33%, And without oil, thus eliminating the potential hazards of traditional traction and hydraulic systems Petroleum pollution and fires.



结构坚固、安全可靠

Stably construction, Safe reliable

高强度的轿厢结构、关键部件的优化设计提升了整体结构的牢固性与安全性,有效保证了货物和人员运输的安全。

The high strength car structure, key component's optimization design has promoted overall construction reliability and security, which effectively guarantees motor transport's security.

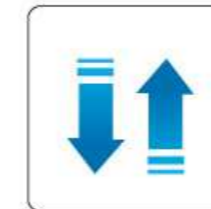

空间开阔、畅快出入

Open space, Freely access

采用多折式厅轿门系统,达到最大开门宽度,使开门更加开阔,入口安全灵敏的光幕门保护,形成一道道光幕保护屏障,有效保护货物和人员的安全进出。

Uses the 4 panels opening door system, achieves the most wide open door width, causes to open the door is more open, the entrance safe keen light-beam door protection, forms an optical curtain protection barrier, protects automobile's outward appearance effectively



专业设计、结构紧凑

Open space, Freely access

专业的设计、技术处理能力与不同井道特点相结合,在充分提高井道利用率的同时,满足不同客户的需求。

Professional design and technical capabilities combine with different characteristics of the shaft,full improve utilization of the shaft meanwhile meeting the needs of different customers.

智能科技，领先超前

Leading intelligent scientific technology



高端高效 创造全新的运载服务

High-end and efficient lift produces
A brand-new transport service

新型64位微电脑控制系统

New 64-bit microcomputer control system

格尔森电梯选用64位CPU,主从CPU相互监控,更大程度提高了数据处理速度;系统内设置的高智能微电脑模块,对电梯运行实施最安全、精确、高效的管理控制。

GERSON elevator adopts 64-digit CPU, inter-monitor of master-slave CPU increase the data processing speed to the greater extent. The highly intellectual micro-computer module inside the system implements the most secure, accurate and effective management and control towards the lift running.

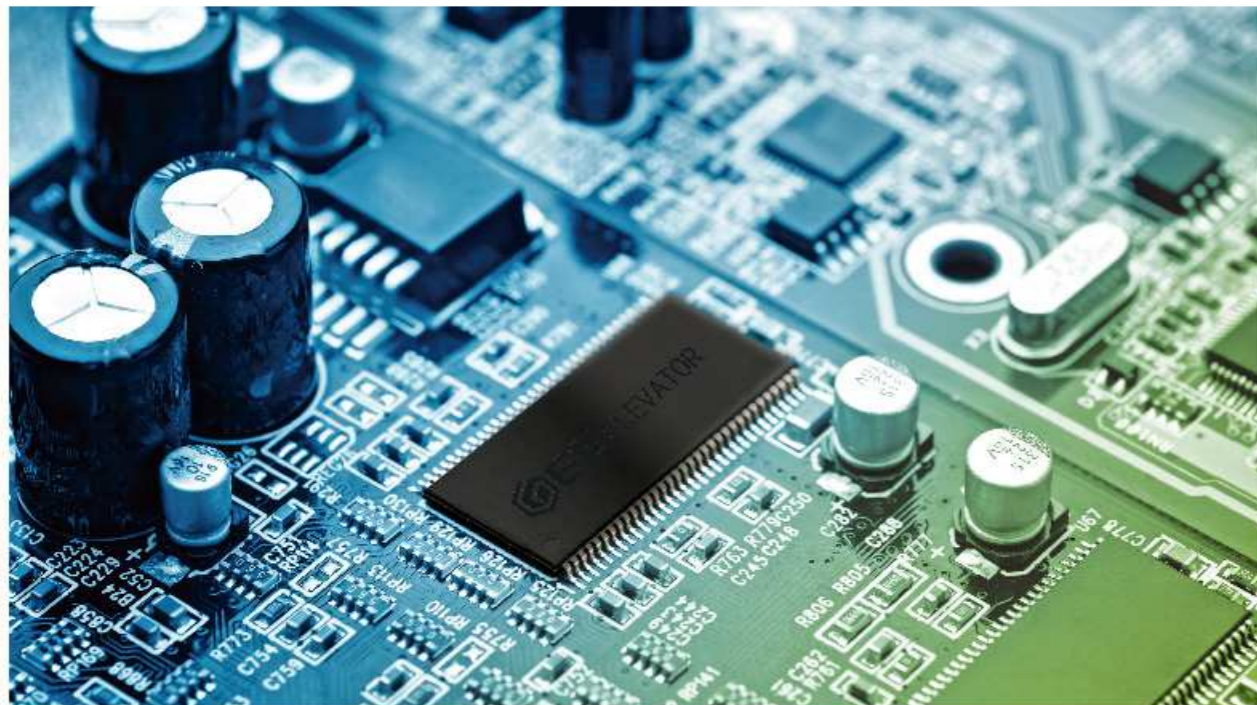

VVVF变频门机系统

VVVF variable frequency door machine

采用智能化中央微处理器,VVVF变频变压门机控制系统,具有高度的稳定性和出色的灵敏度,实现了电梯开、关门的轻缓、平稳和安全。

Adopts intelligent central microprocessor, VVVF variable voltage variable frequency door control system, possessing high level of stability and excellent flexibility, realizing slow, stable and safe opening and closing of door.

远程监控系统

Remote monitoring system

通过 INTERNET、无线局域网等现代通讯工具将电梯的运行信息和故障信息传送至监控中心和维保人员手机,确保专业人员第一时间为客户排除隐患,为电梯安全运行提供重要保障。

Transmit operation information and malfunction information of elevator to monitoring center through Internet, wireless LAN and so on to ensure exclusion of potential risk for clients in the first time and provide Significant guarantee as to safe operation of elevator.



三维红外保护器

Three -dimensional infrared protector

高度灵敏,备感安心

- 154束高灵敏平面光束,内置19束3D光束,给予电梯门及乘客更好的保护。
- 2D/3D光束两种模式一体,安装调试简单方便。
- 全面测试并符合相关国际标准,具有优越的抗电磁干扰性能。
- 3D红外保护器使载货电梯的故障率下降30%-50%。

High level of flexibility, be at ease

- 154 plane beam with high sensitivity with built-in 3D light beam, providing with elevator door and passenger with better protection.
- Integration of two patterns of 2D/3D light beam with simple and convenient debugging.
- Make comprehensive testing conforming to related international standard, possessing outstanding anti-electromagnetic interference performance
- 3D infrared protector reduces malfunction rate of goods lift by 30% to 50%.

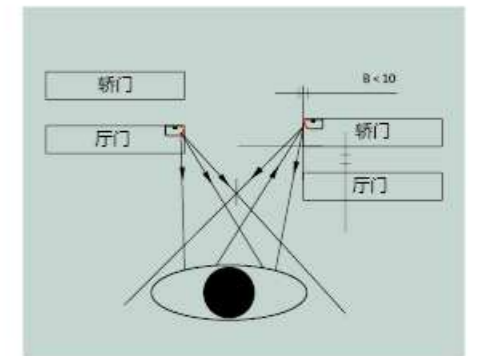

三维 (3D) 红外线工作原理及探测范围
Three-dimension (3D) infrared working
Principle and exploration scope

载货电梯 Freight Elevator



承担重任 不辱使命

Undertake important responsibility, successful
Accomplishment of mission

在物流领域,在工厂、仓库、购物中心、超级市场、机场、车站等不同的场所需求中,格尔森电梯货用系列的发展已臻成熟,我们生产的电梯产品多达几十种,载重量跨度从500公斤到5000公斤,长期以来奠定了格尔森货用电梯“节能、减噪、恒力、精准”的技术和生产优势,完成了对客户高效能和高人性化的服务。

In the logistics field, GERSON freight elevator series are getting well-developed for various requirements out of different occasions such as the factory, warehouse, shopping center, super-market, airport, bus station etc. GERSON produces more than dozens of the lift products. Load ranges from 500kg to 5000kg. Over the years, it has laid a solid foundation to the manufacture advantages, the precise and constant technology with sound energy-saving and noise-reduction. GERSON freight elevator completes the effective and highly humane services to vast customers.



优良技术,舒适节能

Cellent technology, comfortable energy
Consumption

采用VVVF调速技术,大幅减少供电容量,比传统的交流双速技术节能近40%,最大限度地减少电梯功耗,因而成为目前载货电梯调速技术发展方向的先行者。该技术不仅能调节电梯速度,还拥有恒定的力矩特性,不计载荷轻重,能极大地改善电梯运行的舒适感、平层精准度、并减小运行噪音。

Adopt VVVF speed adjustment technology, greatly reducing power supply capacity, saving energy by 40% than traditional exchange technology, reducing power dissipation to the largest extent, as a result, and becoming pioneer of current speed adjustment technological developmental direction of goods lift. The technology can not only adjust speed of elevator, but also possess constant moment feature irrespective of load, which can greatly improve sense of comfort of elevator operation, accuracy of leveling and reduce operational noise.

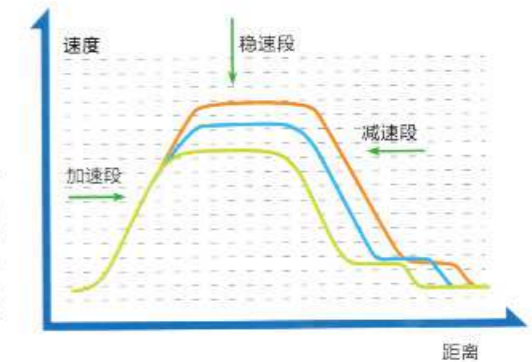

加减速曲线对比
A comparison of accelerating and decelerating curves

规格齐全,更多选择

Completed specification with more choices

速度档次可调,载重跨度大,轿厢规格全,产品多达几十种,这是格尔森货用电梯为契合于客户的不同需要,综合运用电梯先进生产技术的成果。

更精技术,更强动力,更大空间,更好服务,更多选择,这是格尔森货用电梯永恒的脚步。

Adjustable speed grades, large load span, completed lift car specification, with dozens of types of products, which are achievements made through comprehensive application of elevator advanced production technology in order to satisfy different needs of clients with GERSON freight elevator.

More precise technology with stronger power, larger space, better service, more choices which are permanent steps of GERSON freight elevator.

无机房载货电梯

Machine Roomless
Freight Elevator



节能先行者，载货更随意

An energy-saving pioneer with more free load

格尔森无机房载货电梯采用先进的永磁同步无齿轮曳引技术,因此无需减速装置进而改进了电梯井道内的布局方式,因而无需机房;无齿轮曳引机重量轻、体积小等特点,更节约了建筑空间,大大提高了无机房载货电梯的性能与品质,降低了故障率。

格尔森无机房载货电梯具有结构严谨、经久耐用、开门距大、运行平稳安全等优良品质。成为工厂、仓库、百货大厦、物业中心、图书馆等单位运输货物的最佳选择。

"GERSON" serial machine roomless freight elevator merges with advanced permanent magnet synchronous and gearless traction technology to greatly enhance the performance and quality of the freight elevator. Gearless traction machine has light weight and small volume which can save construction space and reduces the failure rate.

"GERSON" serial machine roomless freight elevator becomes the best choice for transporting the freight in the units such as the factories, warehouses, department stores, housing property centers, libraries and so on.



新一代变频调压调速技术

New generation variable frequency voltage regulation and speed governor technology

节能,环保,免维护,舒适感好,低噪音,体积小。

It is of the remarkable energy-saving, environmental protection comfortable travel, maintenance-free, low noise and small bulk.

变频门机

AC variable frequency door machine

先进的技术不仅节能,更提高了开关门的精度及舒适度。

The advanced technology not only saves the energy, but also increases door opening / closing accuracy and the comfortable travel.

待机休眠技术

Standby & sleep technology

在电梯待机时自动切断电梯内的照明及通风设备。

When the elevator is in stand-by mode, it automatically cuts off the lighting and ventilator fan in the elevator.

电梯设备总面积节省25% 空间占用率减少40%

It saves 25% of total lift equipment area
It reduces 40% of space occupation

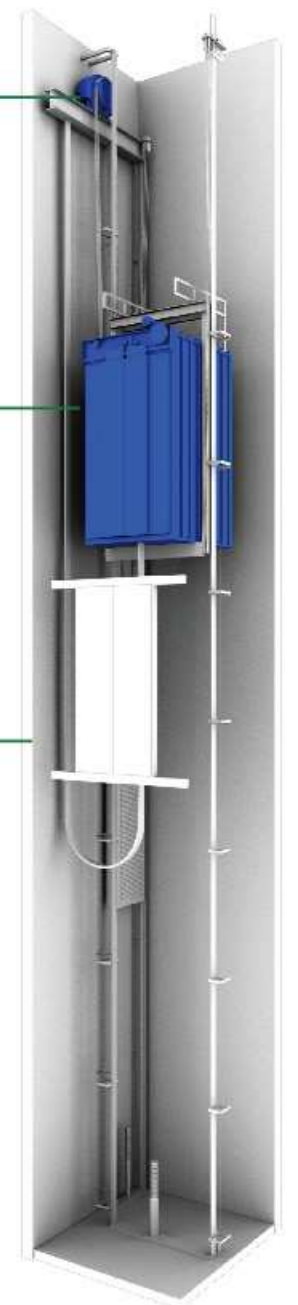
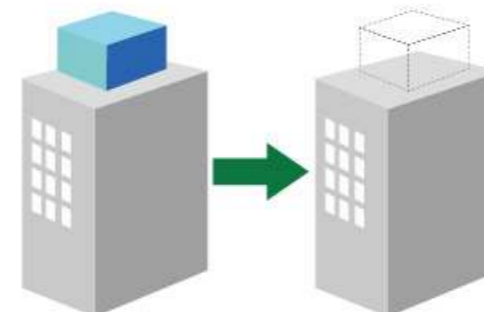

汽车电梯 Car Elevator



高效率的汽车运载保姆 Effective car transport nanny

随着经济的发展,人们的生活条件不断提高,汽车逐渐走进寻常百姓之家。格尔森电梯以高安全性、高舒适性的设计理念,组合配置了高可靠性的一体化控制器。

格尔森电梯制造生产的汽车电梯,可广泛用于停车场、汽车修理厂、汽车销售商、地下车库等场所,无疑是您用梯的首选。

With economic development, people's living conditions are improved by vehicle into the ordinary people's homes. GERSON elevator with high security, high-comfort design philosophy, combining equipped with high-reliability integrated controller.

Gerson elevator manufacturing car elevator, can be widely used in car parks, car repair shop, car dealers, underground garages and other places, no doubt your first choice to use ladders.

成熟的变压变频技术

The matured variable volage and variable freuquency technology

格尔森汽车电梯采用了成熟的变压变频(VVVF)控制技术,通过专用变频器进行极为精确的调速控制,有效提高了运行的平衡,同时节省能源。为了提高汽车进出时的安全性,把VVVF控制技术从电梯驱动系统延伸运用到门机系统中—电脑控制的VVVF调整驱动装置,加上与之匹配的无连杆门机,提高电梯门开关的灵敏度并自动调整每楼层最适合的开关速度,令汽车出入更加自由、安全。

GERSON using a mature vehicle elevator VVVF (VVVF)control technology, through a dedicated inverter for a very precise speed control, effectively improve the balance of running at the same time save energy. GERSON car elevator to improve the safety car out, turning VVVF control technology extends from the elevator drive system applied to the door system -a computer-controlled adjustment of VVVF drives, coupled with matching non-link gate machines, improve the staircase door and automatically adjusts the sensitivy switch on every floor of the most suitable switching speed, makes the car more freely accessible and safe.



格尔森汽车电梯,采用高度成熟的变压变频控制技术精确调速控制,避免了因轿厢受力不均而导致的曳引系统负载加重而产生噪音及轿厢抖动,最大程度优化了这一系列产品的特性。

GERSON car elevator, using highly sophisticated variable voltage variable frequency control technology precise speed control, traction system to avoid uneven force caused by the car load of aggravation noise and jitter car, this series is optimized to maximize characteristics of the product.

安全导向装置

Safety guide device

轿内地面设有安全导向装置,保证了电梯及汽车的安全。

Safety guide device sets in the car ground to ensure fine security of both the cars and the elevators.

可以前后开门

Front/rear door opening are available

电梯轿厢设有前后开门,更方便了汽车进出轿厢和安全。

The elevator car sets front/rear door opening which is more convenient for the safety sector and for the cars to enter into/exit from the elevator cars.

无线遥控按钮

Wireless remote control button

轿箱内设有两只操纵箱按钮和无线遥控开关,司机无须走出汽车,就可以操纵电梯。

There are two operation box buttons in the car. Therefore the driver can operate the elevator in the car without stepping out of it.

专门显示系统

Special display system

专门的电路控制及显示系统,既方便轿内司机,又方便轿外候梯的司机。

Special circuit control and display system is convenient for the drivers inside/outside the car.



杂物电梯

Dumbwaiter Elevator



细节之处显优越

The place of the details shows the superiority

杂物电梯是一种门外按钮控制的小型梯,适用于宾馆、饭店、学校、图书馆、仓库、轮船舱内运送轻便货物、饭菜和图书杂物等物品。

杂物电梯的厅门采用直分式,开门方式为手动。厅门有单开门和双开门之分,装潢分为钢板烤漆和发纹不锈钢。具有豪华美观、操作方便、运行平稳等特点。

Dumbwaiter elevator is a button on the control of a small ladder for hotels, restaurants, schools, libraries, warehouses, ship cabin delivery of light goods, food and books, sundries and other items.

Dumbwaiter elevator Door with straight fractions, open approach to manual. Door with single door and double door of the points. interior paint and hair pattern is divided into stainless steel plate. With the luxury and beauty, easy to operate, running smoothly and so on.

优越显著,完美感受

Significantly superior to a perfect experience

占用空间小,无需很强的土建承载力,无论对新旧建筑物均能实现完美、经济的设计。

Small space, without a strong civil capacity, both old and new buildings can achieve the perfect, economical design.

使用先进的微机控制模块使电梯运行平稳、平层精确。

The use of advanced computer control module that elevator stable operation, smooth layer is accurate.

人性化的设计使其操作更灵活。

Humanized design makes the operation more flexible.

由于其载重量小的特点,可以分为窗口式和落地式两种。

Because of its load feature, can be divided into two Window and Floor-standing type.

本系列杂物电梯安全、实用、雅致、宁静、操作灵活且易于维修,具有多种标准系列的品种和规格,亦可根据用户需求专门设计。

This series of bulk elevator safety, practical, refined, halcyon, flexible operation and easy to maintenance, Has a variety of standard series of varieties and specifications, and may also be designed according to user's requirements.



落地型
Ground type



窗口型
Window type

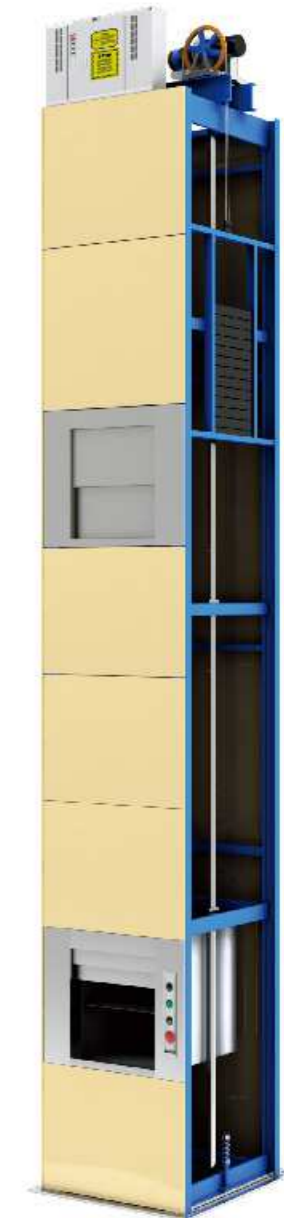

载货电梯轿厢装饰

Freight elevator car decoratic



旁开式 Side opening



中分双折式 center-opening& Double- folded Type

GES-001 标配 Standard

项目Item	规格 Style
轿顶 Car ceiling	钢板烤漆 Painted steel
轿壁、轿门 Car wall、 car door	钢板烤漆 Painted steel
操纵箱面板 C.O.P	发纹不锈钢 Hairline stainless steel
操纵箱面板 C.O.P	花纹钢板 Curved linde steel
地坎Sill	钢地坎(≤3T) Steel sill(≤3T) 铸铁(>3T) Cast iron(>3T)

GES-002 选配 Optional

项目Item	规格 Style
轿顶 Car ceiling	发纹不锈钢 Hairline stainless steel
轿壁、轿门 Car wall、 car door	发纹不锈钢 Hairline stainless steel
操纵箱面板 C.O.P	发纹不锈钢 Hairline stainless steel
操纵箱面板 C.O.P	花纹钢板 Curved linde steel
地坎Sill	地坎(≤3T) Steel sill(≤3T) 铸铁(>3T) Cast iron(>3T)

厅门装饰

Landing door series



旁开式 / Side Opening

标配 Standard

门套	喷塑钢板
层门	喷塑钢板
地坎	压制硬铝
Jamb	Spray steel
Landing door	Spray steel
Sill	Stamped hard aluminum

中分式 / Center Opening

选配 Optional

门套	喷塑钢板
层门	喷塑钢板
地坎	压制硬铝
Jamb	Spray steel
Landing door	Spray steel
Sill	Stamped hard aluminum



中分双折式 / Center-opening & double-folded type

选配 Optional

门套	喷塑钢板
层门	喷塑钢板
地坎	压制硬铝
Jamb	Spray steel
Landing door	Spray steel
Sill	Stamped hard aluminum

操纵盘及外呼

Operation panel and outer calling

按照人体工程学设计的轿厢操纵箱,手感细腻,反应灵敏,操作方便自如;精致的层站显示器,清晰、迅速地显示各种数码及符号。

It designs the car operation panel according to the ergonomics principle. It feels fine and exquisite with the sensitive reaction. It can be operated at ease. The delicate landing display can clearly and promptly display various numbers and symbols.



GES-001



GES-001a

地板
Floor



GES-01
花纹钢板
Checked steel plate

可选防撞条
Optional crash barrier



木质 Wooden

黑色橡胶 Black rubber



色卡
Colors
card



GES-001 GES-002 GES-003 GES-004 GES-005 GES-006

载货电梯功能表

Freight Elevator Function Table

Changeable styles, free configurations

风格千变 配置随心

标准功能/ Standard function

运行功能 Travel function	自动运行 Automatic running	电梯在无人操控的情况下,按照给出的指令自动运行,将自动到目的楼层。 When there is no attendant who operate elevator, elevator will run to the destination floor according to the instruction of passengers automatically.
	司机运行 Attendant running	电梯由司机进行操控,司机按按钮给出指令,电梯按指令要求驶向目的层。 Elevator is operated by attendant, attendant press car calls as request of passengers and elevator will run to the destination floor according to the car calls.
	开门时间自动调整 Automatic adjustment of door open holding time	按照楼层召唤或轿厢召唤的区别,自动调整保持开门时间。 According to current registered landing call and call call situation, system will automatically adjust the door open holding time.
	本层重开门 Door re-open at current floor	关门途中,可以按本层站召唤按钮使门重新开启。 When door is closing, door can re-opened by pushing landing call button at current floor.
	指令误登记消除 Car call cancel	误按了轿内楼层指令按钮,重新按一次,即可撤销误选登记。 If passengers press the wrong floor button in car, same button press it again can cancel the wrong register.
	驻停 Parking	关闭电锁后电梯进入驻停状态,电梯不再响应任何外呼。 When electric key switch is turn off, elevator enters into parking state, it will not serve to any landing call.
	轿厢到站钟 Car arrival gong	装于轿顶的电子钟的钟声告知乘客电梯已到达。 Arrival gong on the car top advices passengers that elevator arrives.
	多射线门传感器 multi-ray door sensor	射线被遮挡时,关门动作立即停止且自动开门。 When ray is sheltered, door will stop closing at once and automatically open.
	超载停驶 Overload stop	轿厢超载时,电梯门常开,蜂鸣器鸣响并停止于该层站。 When elevator is overload, elevator door keeps opening, buzz rings and elevator stops at the current floor.
	检修操作 Inspection operation	当进入检修状态时,轿厢以低速点动运行。 When elevator enters into inspection state, car runs in jog state.
安全功能 Safety function	故障自诊断 Troubleshooting	控制器可记录故障,以便快速排除故障,迅速恢复电梯运行。 Controller can record faults in memory to facilitate the fault elimination and restore elevator running.
	故障自动停靠 Auto-landing with fault	运行中系统发生故障,安全回路有效的前提下,电梯就近层开门。 When there is any fault occurred in elevator running, when safety circuit is valid, elevator lands to the nearest floor.
	重复开关门 Door close repeat	关门过程中,有时因阻碍或干扰,电梯门会重复打开或关闭。 On normal mode, after running door close command, if door inter-lock circuit isn't connected, elevator opens door and closes it again.
	上下越层及上下极限保护装置 Top/bottom limit and final limit protection	该装置可有效防止当电梯万一发生失控时的冲顶或撞底现象,使电梯更安全可靠。 The devices can prevent elevator from crashing to the top or bottom of hoistway in case that elevator is out of control with fault. It ensures the safety and reliability.
	下行超速保护装置 Down running protection	当电梯下降运行超速时,该装置自动切断控制电源,使电机停止运转,限速器动作,强制电梯停止运行,保障安全。 When elevator runs down in over speed, this device cuts off the control power to stop the motor running, speed limiter is motivated to force elevator to stop and ensure the safety.
	上行超速保护装置 Up running protection	当电梯上行超速时,该装置自动将电梯减速或制停。 When elevator runs up in over speed, the device forces elevator to decelerate and braking.
	安全回路保护 Safety circuit protection	安全回路断开,或安全回路接触器粘连,电梯立即停止。 When elevator circuit is open or contacts are adhered, elevator stops running at once.
	门联锁保护 Door interlock protection	所有厅轿门全部关闭,电梯方可运行,当门锁接触器粘连时,电梯立即停止。 Only all doors are completely closed, elevator can run. When door interlock contacts are adhered, elevator stops running at once.
	主接触器保护 Main contactor protection	系统随时检测主接触器动作是否可靠,发现异常,立即停止运行。 System detects if the main contactor acts reliably, if any abnormal is detected, elevator stops running at once.
	抱闸检测保护 Brake detecting protection	对抱闸臂的打开和闭合实时检测,若发生异常,或抱闸接触器粘连,电梯禁止启动。 System detects the brake state, if there is any abnormal or braking contacts are adhered, elevator can't start running.
人机界面 Man-machine interface	微动指令按钮 Micro push button	轿内操纵指令按钮及层站召唤按钮采用新型微动型按钮。 C.O.P. and H.O.P. both adopts new micro push button.
	运行状态显示 Running state display	系统能显示电梯运行方向、层楼、开关门、故障等信息。 System can indicates running direction, floor, door state, default ect.
	不停层任意设定 Non-stop floor set	可根据用户需要任意设定不停靠层站。 Set the non-stop floor according to the customer' requirement.

人机界面 Man-machine interface	待梯层任意设定 Homing floor set	可根据用户需要任意设定待梯层站。 Set the homing floor according to the customer' requirement.
	井道参数自学习 Hoistway self-learning	通过自学习,系统将自动测出各层楼的距离数据,并永久保存。 Through hoistway self-learning, system can measure out the distance between each floor and record them permanently.
应急功能 Emergency function	应急照明 Emergency lighting	停电时,自动打开轿内应急照明。 When power is off, car emergency light is on automatically.
	紧急电动运行 Emergency electric operation	当进入紧急电动状态时,轿厢以低速点动运行。 When elevator enters into emergency electric operation state, elevator runs in low speed inching running.
	五方通话装置 5-way intercom	通过对讲机,可让轿内、轿顶、电梯机房、井道地坑、救援值班室之间实现相互通话。 Communication between car inner, car top, machine room, pit and security room through intercoms is realized.
节能功能 Energy-saving function	警铃 Alarm bell	紧急时,连续按下轿内操纵台上的警铃按钮,安装于轿厢顶上的警铃会鸣响。 In emergency situation, pressing the alarm bell button on C.O.P. continuously, alarm bell on car top will ring.
	风扇、照明自动关闭 Fan & light automatic off	在规定的时间内没有召唤或指令信号,轿厢内风扇和照明会自动关闭,以节能。 If there is no car call or landing call in a preset time, car inner fan and light will be turn off automatically.

选配功能 Optional Function

运行功能 Travel function	自动关门时间延长 Door close delay	按轿厢内的专用按钮,可使门在一段时间内保持开门状态。 Pushing the door open button in car can prolong the door open state for a period.
	消防返回 Fire emergency return	消防状态下,所有召唤均被取消,电梯立即驶往指定救援层站停靠,并自动开门。 In fire emergency state, all landing calls are eliminated, elevator runs to the preset floor and open door.
	并联功能 Duplex control function	用于两台电梯并联运行,减少候梯时间,以提高运行效率。 This function is for two elevators duplex control, it can reduce waiting time and improve the running efficiency.
	贯通门控制 Opposite door control	通过对贯通门的设置,可控制贯通门在相应楼层的开、关动作。 By setting opposite system can control it's action on corresponding floor.
人机界面 Man-machine interface	轿厢副操纵箱 Sub-C.O.P.	用于大载重量的电梯,以便让轿厢内人员更方便使用。 It is for building with crowded passengers, it facilitates passengers to register call.
	IC卡控制功能 IC card control	所有(部分)层站须经授权,必须用IC卡电梯方可运行。 All (part) of the floors need entry approval, only with IC card can run the elevator.
应急功能 Emergency function	停电自动疏散装置 Automatic Rescue Device (ADR)	停电时,应急装置提供电源,电梯驶往最近层站,自动开门,疏散乘客。 When power is off, this device supplies power to elevator, elevator runs to the nearest floor, open its door and evacuates the passengers.
监控功能 Monitor function	曳引机监控 Traction machine monitor	无机房电梯装于曳引机顶部的探头能随时监控曳引机动作状况。 The monitor for machine room less elevator installed on the traction machine top can monitor the traction machine state.

Shaft layout

载货电梯土建示意图 (紧凑型电梯机房)

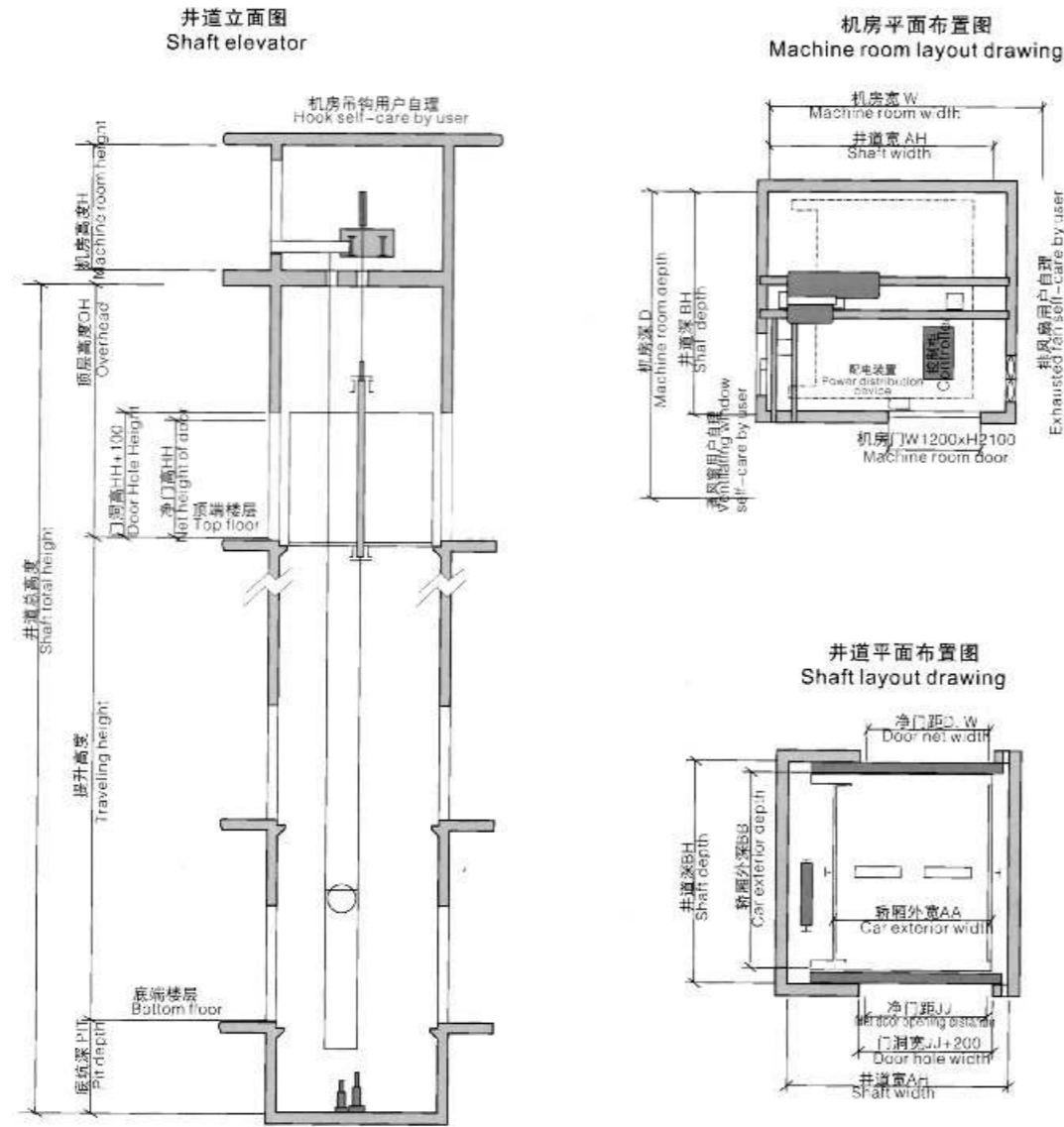

Shaft layout

无机房货梯土建示意图

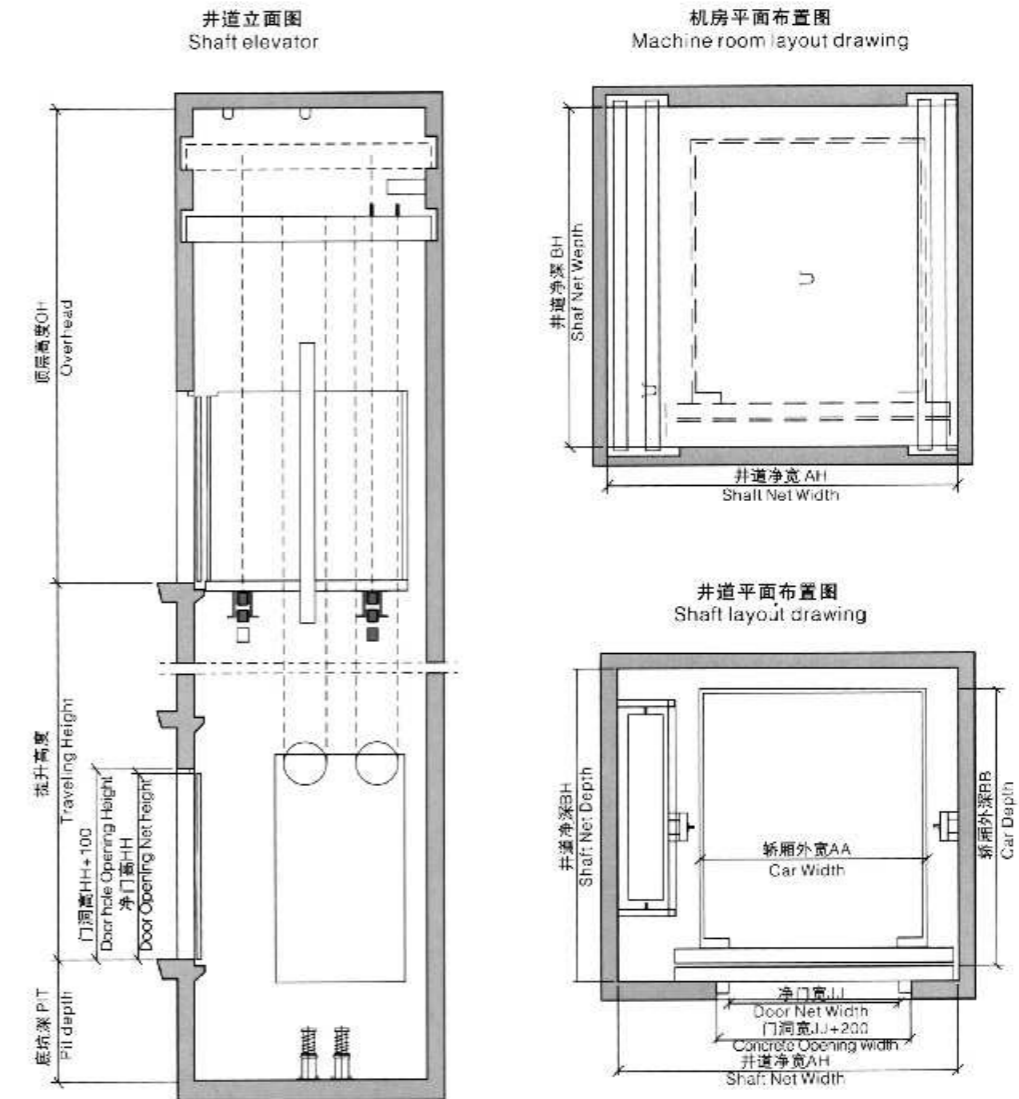

载货电梯参数表 Freight elevator specifications

载重 Load (kg)	速度 Speed (m/s)	轿厢尺寸 Car size (宽 x 深 x 高) (AA x BB x CH)	净开门 Net door opening (宽 x 高) (JJ x HH)	井道净尺寸 Hoistway Net Size (宽 x 深) (AH x BH)	顶层高度 Overhead height OH	底坑深度 Pit depth PIT	最大层站 Maximum landing	最大提升高度 Maximum lifting height (m)	机房净高 Net height of machine room (mm)
1000 非贯通 Non-cut through type	0.5	1400x1600x2200	1300x2100 旁开	2500x2080	4200	1400	6	30	2600
	1				4400		12	60	
1000 贯通 Cut through type	0.5	1700x2400x2200	1500x2100 旁开	2800x2880	4200	1400	6	30	2600
	1				4400		12	60	
2000 非贯通 Non-cut through type	0.5	2000x2800x2200	1700x2100 中分双折	3250x3280	4200	1400	6	30	2600
	1				4400		12	60	
2000 贯通 Cut through type	0.5	2400x3600x2400	2000x2300 中分双折	3450x4080	4200	1500	6	15	2600
	1				4400		12	30	
3000 非贯通 Non-cut through type	0.5	2400x3600x2400	2200x2300 中分双折	3800x4080	4500	1500	6	15	2600
	1				4800		12	30	
3000 贯通 Cut through type	0.5	2400x3600x2400	2200x2300 中分双折	3800x4080	4400	1500	6	15	2600
	1				4500		12	60	
4000 非贯通 Non-cut through type	0.5	2400x3600x2400	2200x2300 中分双折	3800x4080	4600	1500	6	15	2600
	1				4800		12	30	
4000 贯通 Cut through type	0.5	2400x3600x2400	2200x2300 中分双折	3800x4080	4600	1500	6	15	2600
	1				4800		12	30	
5000 非贯通 Non-cut through type	0.5	2400x3600x2400	2200x2300 中分双折	3800x4080	4600	1500	6	15	2600
	1				4800		12	30	
5000 贯通 Cut through type	0.5	2400x3600x2400	2200x2300 中分双折	3800x4080	4600	1500	6	15	2600
	1				4800		12	30	

备注: 标准层高4m
Note: Standard storey height 4m.

注: 上述尺寸供设计参考, 具体尺寸以合同签约时提供的土建图为准。
Note: Only for reference, final manufacture please follow contract.

无机房电梯参数表 Machine Roomless (MRL) freight elevator specifications

载重 Load (kg)	速度 Speed (m/s)	轿厢尺寸 Car size (宽 x 深 x 高) (AA x BB x CH)	净开门 Net door opening (宽 x 高) (JJ x HH)	井道净尺寸 Hoistway Net Size (宽 x 深) (AH x BH)	顶层高度 Overhead height OH	底坑深度 Pit depth PIT	最大层站 Maximum landing	最大提升高度 Maximum lifting height (m)
1000 非贯通 Non-cut through type	0.5	1400x1600x2200	1300x2100 旁开	2500x2080	4500	1600	6	30
	1				4800		12	60
1000 贯通 Cut through type	0.5	1700x2400x2200	1500x2100 旁开	2800x2880	4500	1600	6	30
	1				4800		12	60
2000 非贯通 Non-cut through type	0.5	2000x2800x2200	1700x2100 中分双折	3350x3280	4500	1600	6	30
	1				4800		12	60
2000 贯通 Cut through type	0.5	2400x3600x2400	2000x2300 中分双折	3550x4080	4500	1600	6	15
	1				4800		12	30
3000 非贯通 Non-cut through type	0.5	2400x3600x2400	2200x2300 中分双折	3900x4080	4500	1600	6	15
	1				4800		12	30
3000 贯通 Cut through type	0.5	2400x3600x2400	2200x2300 中分双折	3900x4080	4500	1600	6	15
	1				4800		12	30
4000 非贯通 Non-cut through type	0.5	2400x3600x2400	2200x2300 中分双折	3900x4080	4500	1600	6	15
	1				4800		12	30
4000 贯通 Cut through type	0.5	2400x3600x2400	2200x2300 中分双折	3900x4080	4500	1600	6	15
	1				4800		12	30
5000 非贯通 Non-cut through type	0.5	2400x3600x2400	2200x2300 中分双折	3900x4080	4500	1600	6	15
	1				4800		12	30
5000 贯通 Cut through type	0.5	2400x3600x2400	2200x2300 中分双折	3900x4080	4500	1600	6	15
	1				4800		12	30

备注: 标准层高4m
Note: Standard storey height 4m.

注: 上述尺寸供设计参考, 具体尺寸以合同签约时提供的土建图为准。
Note: Only for reference, final manufacture please follow contract.

Shaft layout

汽车电梯土建示意图

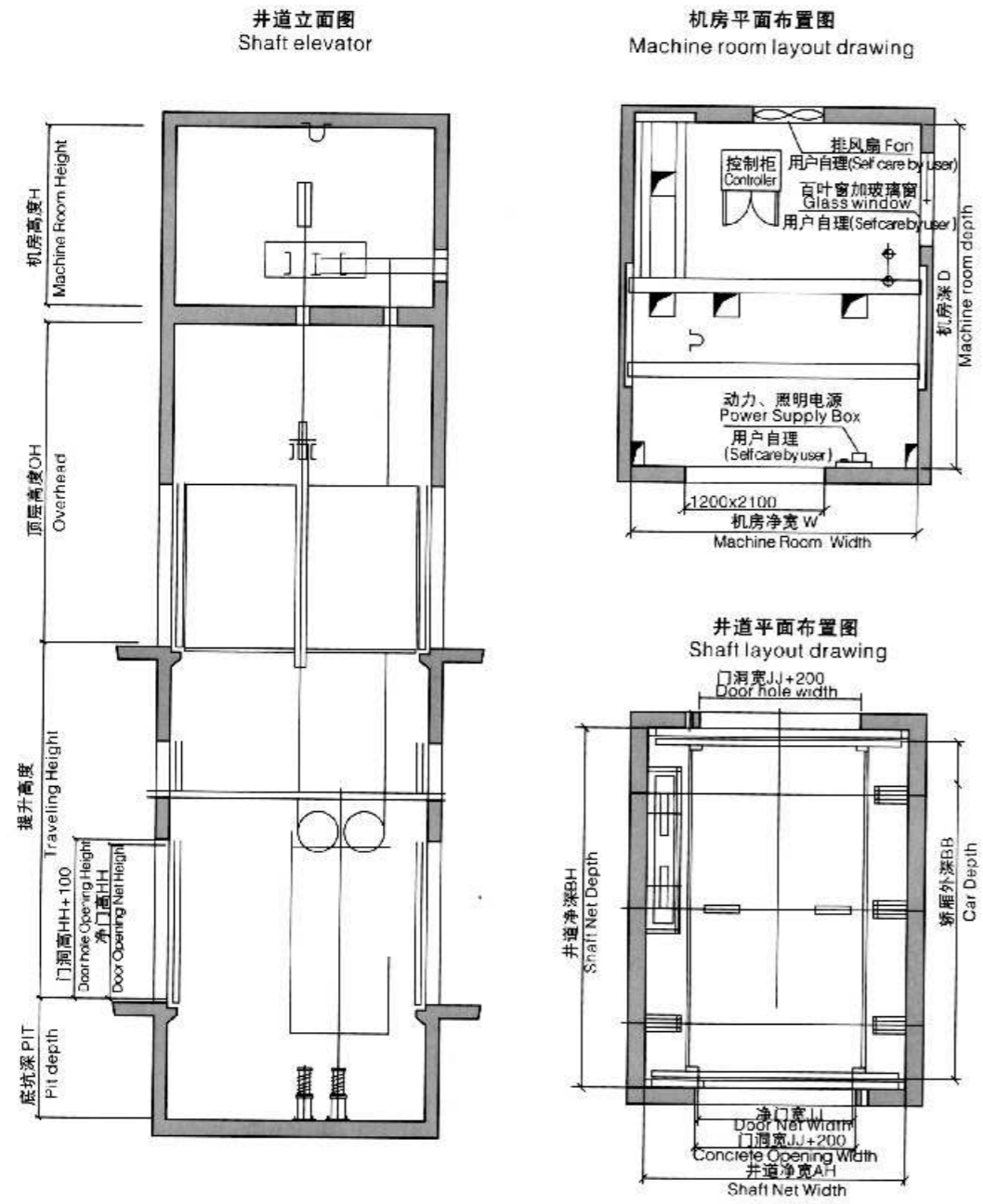

汽车电梯参数表 Car elevator specifications

载重 Load (kg)	速度 Speed (m/s)	轿厢净尺寸 Car net size (宽 x 深) (AA x BB)	净开门 Net door opening (宽 x 高) (JJ x HH)	井道净尺寸 Hoistway Net Size (宽 x 深) (AH x BH)	底坑深度 Pit depth PIT	顶层净高 Overhead height OH	机房净尺寸 Machine Room Net Size (宽 x 深 x 高) (W x D x H)	开门方式 Door Open type
3000	0.5	2400x6000	2400x2400	4100x6300	1600	4800	4100x6300x2500	中分双折 Four panel center opening
5000	0.5	3400x7200	2600x2400	4600x7700			4600x7700x2500	双折侧开门 Two panel side opening

注：上述尺寸供设计参考，具体尺寸以合同签订的土建图为准。
Note: Only for reference, final manufacture please follow contract.

Shaft layout

杂物电梯土建示意图

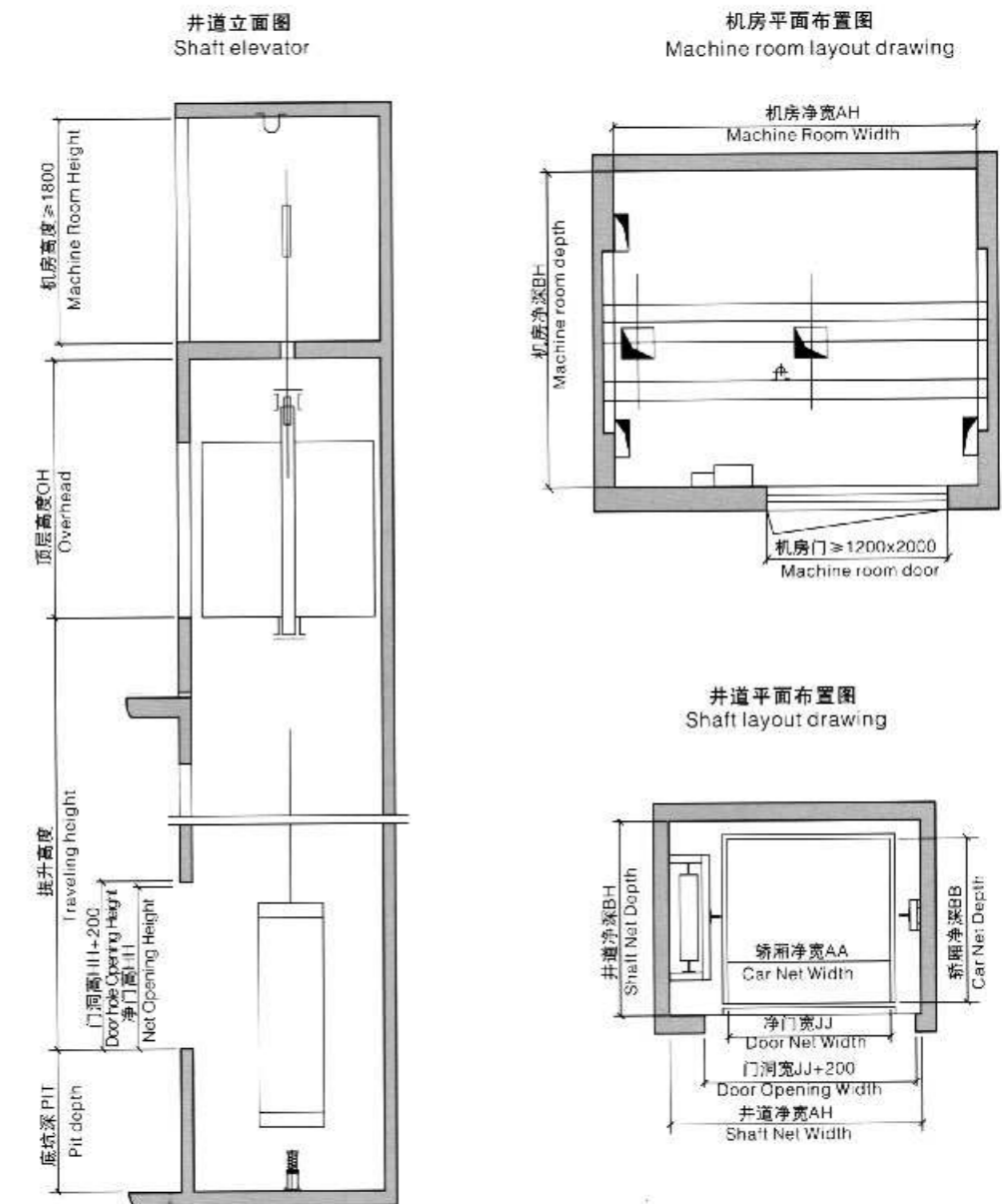

杂物电梯参数表 Dumbwaiter elevator specifications

载重 Load (kg)	速度 Speed (m/s)	轿厢净尺寸 Car net size (宽 x 深) (AA x BB)	净开门 Net door opening (宽 x 高) (JJ x HH)	井道净尺寸 Hoistway Net Size (宽 x 深) (AH x BH)	底坑深度 Pit depth PIT	顶层净高 Overhead height OH	开门方式 Door Open type
100	0.4	700x800	700x1000	1300x1100	1000	3000	上下直分式 up/down straight opening
200		950x950	950x1000	1550x1200	1000	3000	上下直分式 up/down straight opening
250		1000x1000	1000x1000	1600x1300	1000	3000	上下直分式 up/down straight opening

注：上述尺寸供设计参考，具体尺寸以合同签订的土建图为准。
Note: Only for reference, final manufacture please follow contract.

物联网介绍

Introduction to the Internet of things



全程服务,让心与心更靠近

Full-cours dervice, heart-to-toheart connection

服务不仅仅是要保证安全,保障您设备方面的投资,真正的服务是预见和满足顾客特别的需求。正因为服务的定义随着顾客需求的不同而不同,我们满足这些需求的方法也是广泛而且个性化的。

Service ont only to ensure safety,protect your investment in equipment,the real service is to anticipate and meet the spacial needs of customers.because the denifition of services with different customer needs and different ways to meet those needs we also extensive and personalized.

维护保养解决方案 Maintenance

通过专业、全面的“预防为主,预检预修”的计划性电梯保养服务,保证电梯安全高效地运行,为客户的资产保值增值。

Professional and full scheduled elevator maintenance service centering" prevention frist ,servicing frist" guarantees running in safe and nign-efficiency way,and can keep value of and appreciate customer's property.



修理/升级解决方案 Repair/ upgrade

经年累月的运转使电梯部件出现磨损,外观和功能也逐渐过时。格尔森修理/升级解决方案基于电梯现有配置,针对客户需求增设附属硬件或进行系统改良,提高电梯设备的安全性、可靠性、运行效率和舒适度,始终满足乘客期望。

Elevator component may be worn, and appearance and function may gradually get out-of-date upon years of running. Based on current elevator configuration, in GERSON repair/upgrade solution, auxiliary hardware is added or system is improved as customer demand to improve safety, reliability, running efficiency and comfort and always meat passenger's expectation.



现代化更新解决方案 Modernization update

以最先进的现代电气控制系统取代老化过时的系统,同时保留有价值的机械部件。不需要新梯的费用,也不影响楼宇的正常运营,却呈现给您一部崭新电梯的价值。

Out-of-date system is replaced with the most advanced modern electrical control system, meanwhile valuable key mechanical components are reserved. On the basis, value of brand-new elevator is brought without cost of new elevator or impact on normal operation of building.



物联网技术为服务加速度

Internet of Things speeds up the excellent services

我们坚信一件产品达到完美水准,其卓越的品质不是全部,只有再加上高标准的服务保障,才能真正为客户创造最大价值,客户才能真正获得该产品带来的超值享受。

以“无处不在的服务,全心全意为客户”的服务理念,格尔森员工提供一年365天,每天24小时的售后服务保障。

We are firmly convinced that the perfect condition of every product shall include high standard service warranty. So it can truly create maximum value for broad customers. And the clients can truly enjoy value-exceeding experience from the products.

Our service ideas: We wholeheartedly serve vast clients from everywhere. GERSON employees offer 365 days a year, 24 hours a day after sale service warranty.

